

574

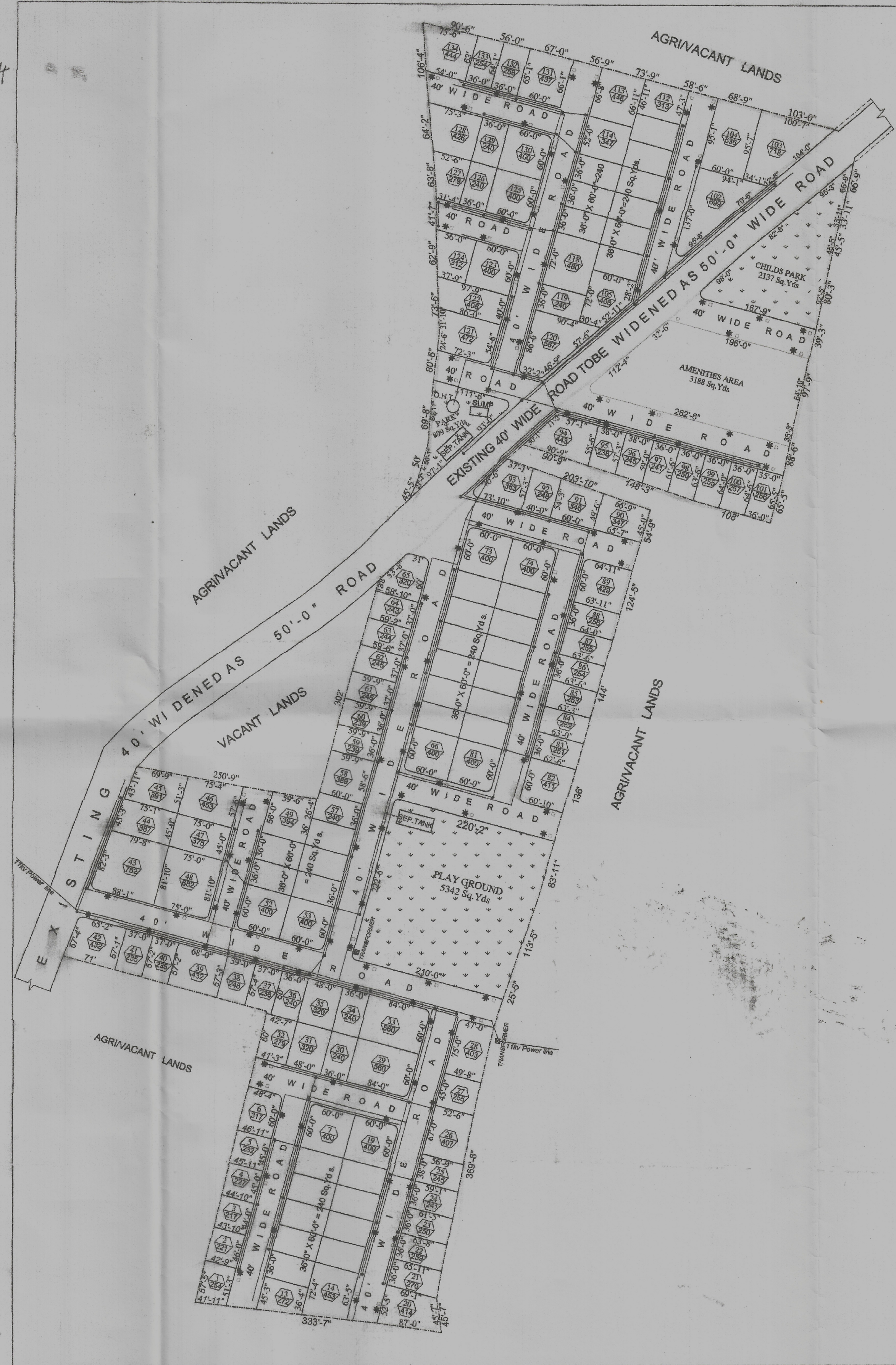

'THE TECHNICAL APPROVAL OF FINAL LAYOUT'

1. Permit No. 06/0/HMDA/SHZ/2008. The final layout is released subject to following conditions.
2. This approval does not constitute an application of the provision of the Urban Land (Ceiling & Regulation) Act, 1973 to the above land.
3. This Final Layout approval does not confer or affect the ownership boundary is the sole responsibility of the applicant.
4. The Final Layout as Released subject to the condition that the External Development of 3rd class township should be paid the Owner/Plot holder as and when demanded by Hyderabad Metropolitan Development Authority.
5. This permission does not bar any public agency including HMDA/Local Body to acquire the lands for public purpose as per Law.
6. If any dispute litigation arises in future, regarding the ownership of a land, site boundaries etc., the applicant shall be responsible for the settlement of the same. HMDA or its employees shall not be a party to any such dispute litigation and draft approved layout plan shall be deemed to be cancelled without notice and action will be taken as per law.
7. The applicant is not permitted to construct the compound wall around the site and not to block the roads or to provide access to the neighbouring plots.
8. The applicant shall deposit any misinterfered documents, fabricated documents etc. with the authority. If approved layout plan will be void and cancelled and action will be taken as per law.

K. Ramesh Babu
 For METROPOLITAN COMMISSIONER
 Hyderabad Metropolitan Development Authority
 (Signature)
 Pot (Seal)

L.P. NO: 06/0/HMDA/SHZ/2008.
 FILE NO: 8246/LO/Plg/SHZ/HMDA/2008.
 Dt. 01.11.2010.

PLAN SHOWING THE FINAL LAYOUT IN SY.NO. 84P, 85P & 93P AT PULIMAMIDI VILLAGE, KANDUKUR (M), R.R.DISTRICT.

BELONGING TO : SRI. MADALA SUDHAKAR & others S/O LATE BHASKARA RAO

SCALE 1" = 100'-0"



REFERENCE :

Lay-out Boundary	=====
Total Lay-out Area	Ac : 15.33 Guntas (or) Ac:15.825 Cents
Existing Roads	=====
Proposed Roads	=====
Septic Tank (S.P) 16.00m x 3.78m x 2.75m	: 2 No's
Water Pipe Lines	-----
Drainage Pipe Lines	-----
Electrical Lines	-----
Man Holes	⊕
Electrical Poles	⊥ EP
Sump	⊠ SUMP
Overhead Water Tank (O.H.T)	⊙
Transformer ⊠ TR	: 1 No's
Water Harvesting Pits ⊕	: 64 No's
Total No. of Plots	: 134 No's
Trees	: *

LAND USE ANALYSIS :

	SQ.YDS	SQ.MTS	PERCENTAGE
PLOTED AREA	42653	35662.17	55.69 %
AMINITIES AREA	3188	2665.49	4.16 %
ROAD AREA	22374	18706.90	29.21 %
OPEN AREA	8378	7004.84	10.94 %
TOTAL AREA	76593	64039.41	100.00 %

SIGNATURE OF ARCHITECT

K. Jagannadha Rao
K. Jagannadha Rao
 B.Tech. M.E.
 L.No:188/Engineer/TPD/HMDA/08
 Pragathi Complex, Flat No.A/2/1
 2nd Floor, L.B.Nagar, Hyd-74.
 Ph: (O) 24037305

SIGNATURE OF APPLICANT'S

M. Sudhakar
M. Sudhakar
 For
 S/O LATE BHASKARA RAO